



8 Lindholme Close Hatfield, Doncaster, DN7 6FW Offers Around £230,000

Occupying an enviable cul de sac position on a sought after roadway within Hatfield is this beautifully presented 3 bedroom semi detached house recently constructed by David Wilson homes. The property in brief comprises; entrance hallway, cloaks/WC, spacious lounge with feature fireplace, stunning open plan kitchen/dining room with a range of integrated appliances, master bedroom with luxury en suite shower room, two further good sized bedrooms and family bathroom. Outside; ample off road parking to the front and enclosed rear garden which is predominantly laid to lawn. The property is appointed to a high specification throughout featuring many builder upgrades and occupies arguably one of the best positions on this modern development. Ideally located close to local amenities and motorway connections this lovely family home is offered for sale with NO ONWARD CHAIN and must be viewed to be appreciated.

- Recently constructed semi detached house
- Three good sized bedrooms
- Spacious lounge with feature fireplace
- Stunning open plan kitchen/dining room with integrated appliances
- Luxury en-suite shower room
- Family bathroom with contemporary suite
- Idyllic cul de sac location
- Ample off road parking
- Rear enclosed garden
- Beautifully presented throughout with many builder upgrades

Viewing

Please contact our Office on 01302 751616 if you wish to arrange a viewing appointment for this property or require further information.



Floor Plan

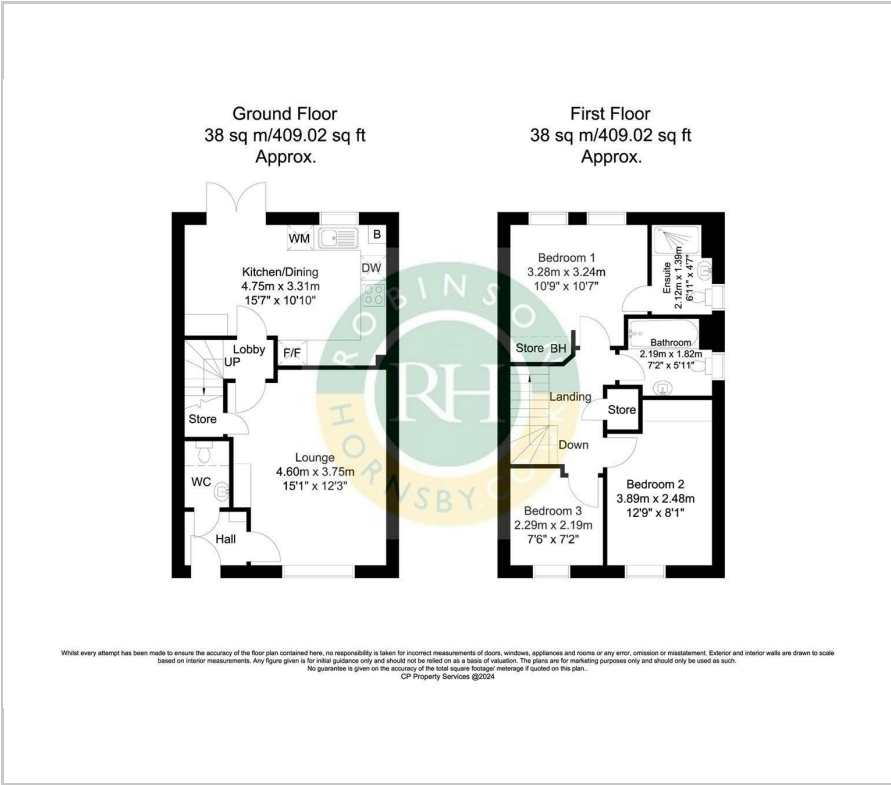

Area Map



Energy Efficiency Graph

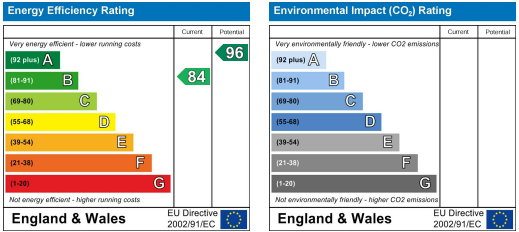

These particulars, whilst believed to be accurate are set out as a general outline only for guidance and do not constitute any part of an offer or contract. Intending purchasers should not rely on them as statements of representation of fact, but must satisfy themselves by inspection or otherwise as to their accuracy. No person in this firms employment has the authority to make or give any representation or warranty in respect of the property.